



Power Relay Quick Start Guide

Introduction

It allows you to turn the power on and off remotely as well as setting on/off schedule from the mobile app.

Get to know your device

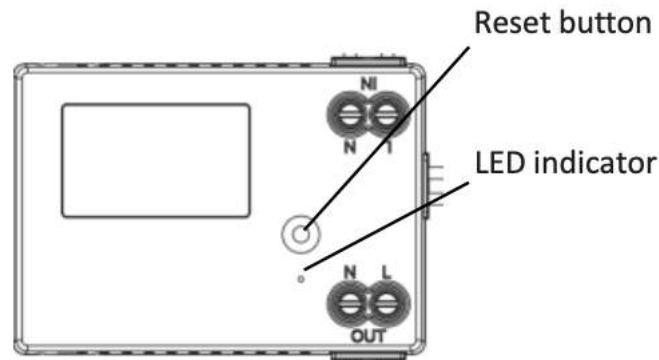

Button

Reset Button

- Return this device to default factory settings.
- Set this device on pairing mode so as to pair with a wireless switch.
- Please use a pin key tool to press and hold the reset button for ten seconds until the LED light flashes twice.

LED Indicator

LED Status	What It means
LED flashing	The device has not joined a network
Green LED solid on	The load is ON
Red LED solid on	The load is OFF
LED flashing three times	Enter pairing mode or return to default factory settings

Get Started

To get started, you will need:

- A Smart Gateway
- A Power Relay
- The mobile app

Then follow the steps below:-

1. Install the Power Relay.

The installation diagram below is one example of a possible application.

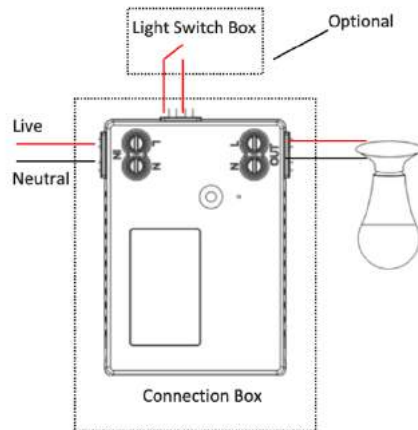

2. Open Maevi (Maevi Smart Home) app and go to “Home Automation” tab. Tap the plus circle button at the below right of the screen to pair the Power Relay with the Gateway.



Pairing Device

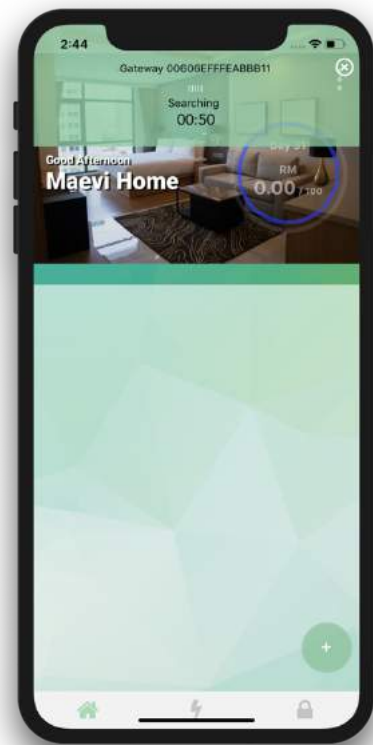

Tip: for this step, you could also press “Z” button on the gateway for 2 seconds until the LED indicator turns solid blue

- The power relay will be added into the gateway, the flashing LED turns solid if pairing is successful. Please go to the app to check if it is successfully added.

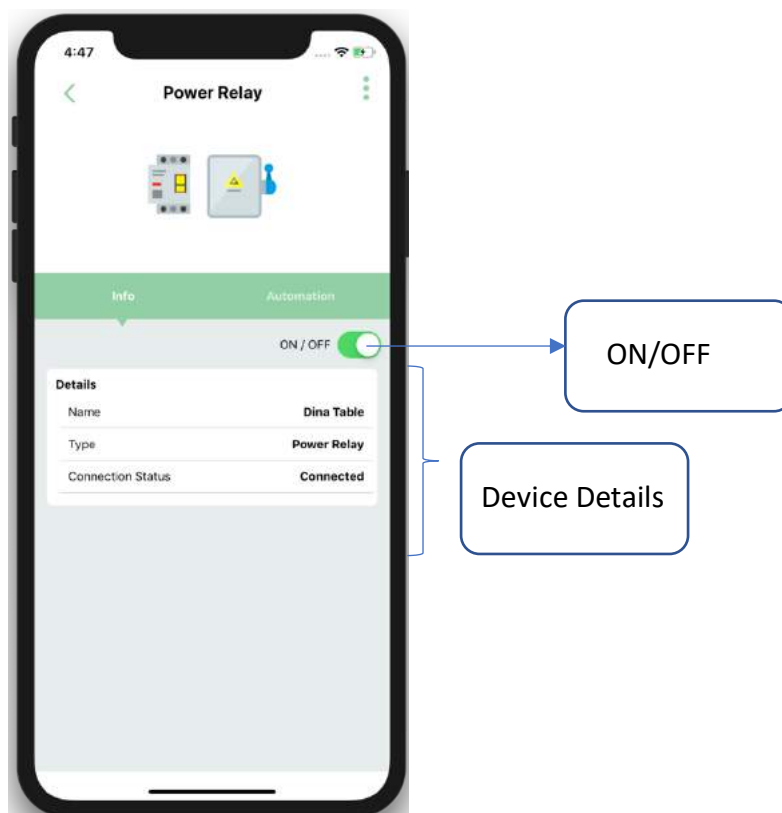
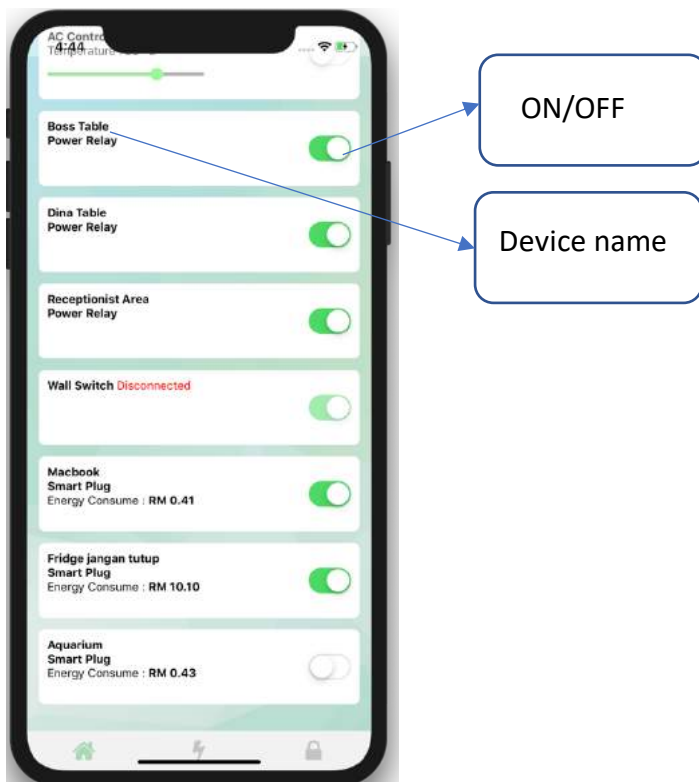

Scheduling Device

4. Create turn ON/OFF scheduling device

