



Maevi Air Conditioner Controller
Quick Start Guide

Introduction

The Maevi Air Conditioner (AC) Controller converts control commands sent using a Zigbee signal into IR (Infra-Red) signal to control your air conditioner system. It allows you to control the system mode, temperature, fan speed, ventilation and swing of the air conditioner remotely from Maevi app.

Get to know your device

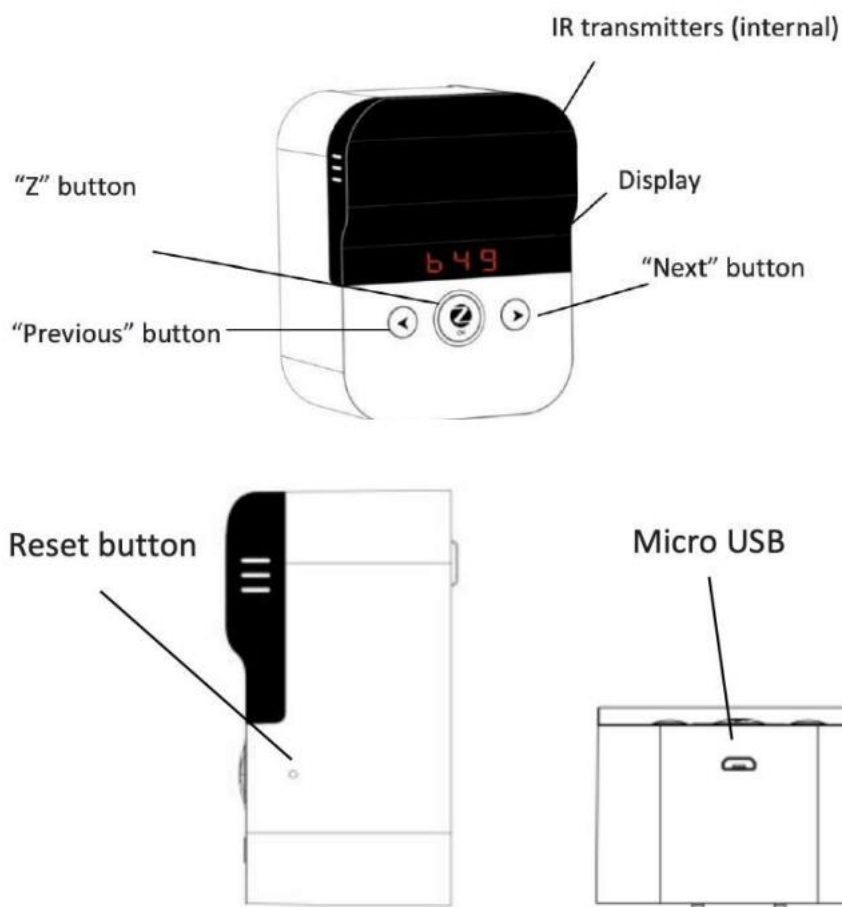

Buttons

"Z" button	<ul style="list-style-type: none"> Searching pairing mode Save the chosen pairing mode Stop searching for a pairing mode Continue to search for a pairing mode
Previous button	<ul style="list-style-type: none"> Switch to the "previous" option Enter the Brand code selection mode
Next Button	<ul style="list-style-type: none"> Switch to "next" option Enter the Brand code selection mode
Reset button	<ul style="list-style-type: none"> Set the device to factory setting

IR Transmitter & Display

IR Transmitters

The IR transmitters are used to communicate with the air conditioners IR receiver normally sent by AC unit remote control.

Display

Used to display corresponding information while operating:-

- Brand Information
- Pairing code information

LED Indicator

LED Indicator	What It Means
Orange LED solid on	The device has joined the Zigbee network
Red LED solid on	The device has not joined the Zigbee network

Get Started

To get started, you will need :

- Maevi Gateway
- Maevi Air Conditioner Controller
- Maevi Mobile App
(Available for download on Google Play Store and Apple App Store)

Then follow the steps below:

1. Insert and power on the Maevi AC Controller into a power socket facing your air conditioner (AC). The LED display indicator will show solid red.
See the diagram below to guide you in selecting a suitable position in the range of the grey bars.

Tips: If the LED indicator is not solid red then please press and hold the reset button for about 10 seconds until the display shows "rst" to return it to the factory default settings.

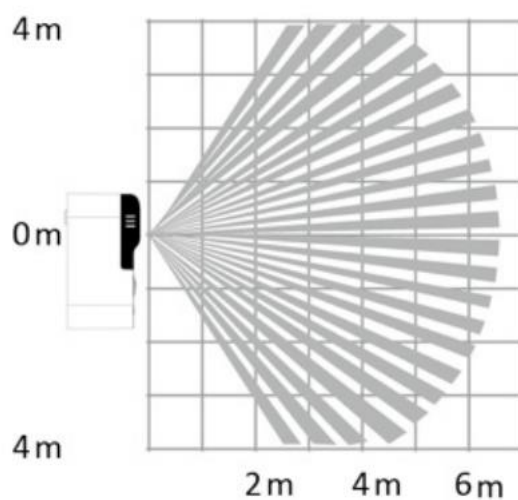

2. Open Maevi App and go to “Home Automation” tab.
3. Select “Add New Device” button to pair the Air Conditioner Controller with the Gateway.

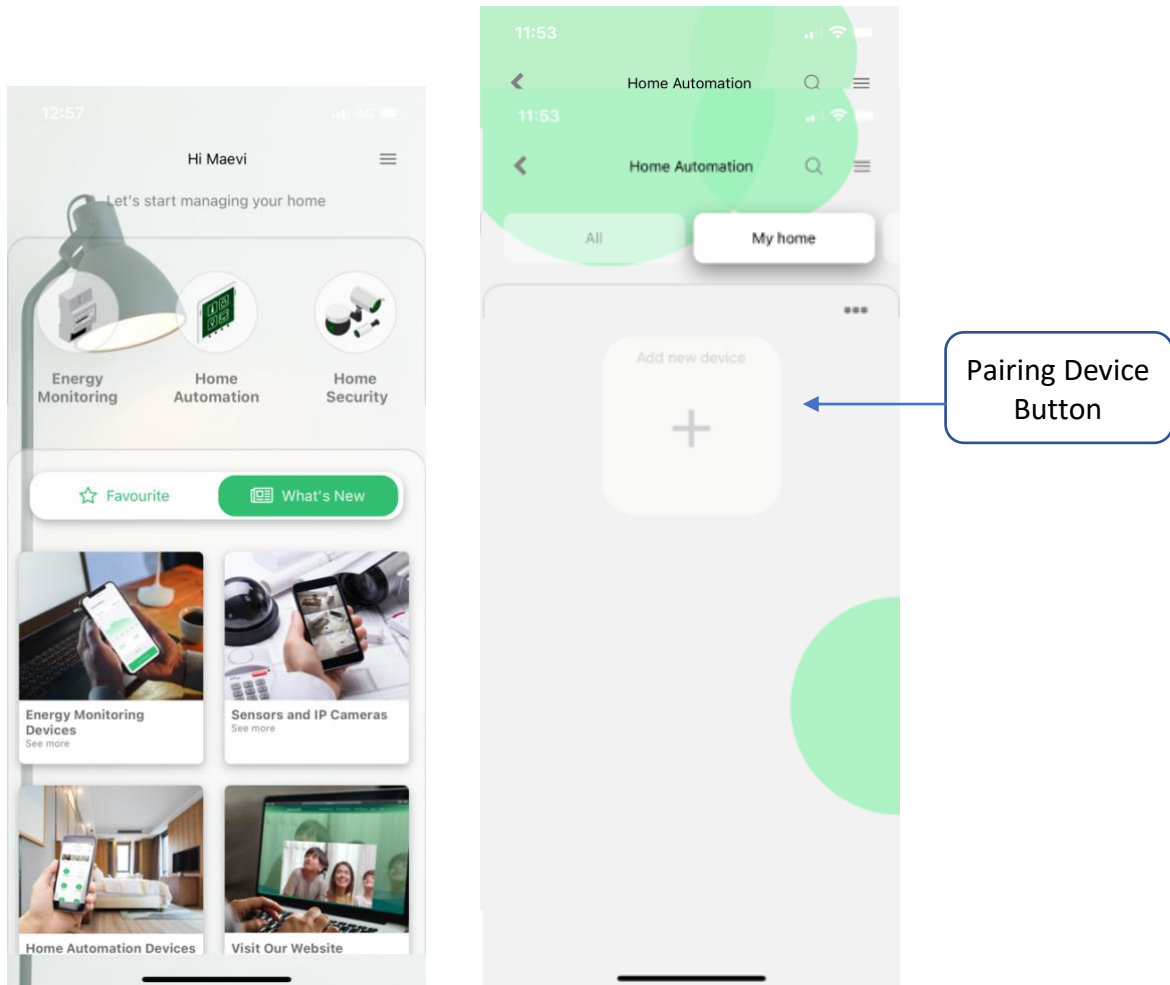

Tips: For this step you could press the “Z” button on the gateway for 2 seconds until the LED indicator turns blue solid.

4. The AC Controller is successfully paired with the Gateway when the LED indicator turn to orange. Now the AC Controller has successfully joined with Maevi gateway.
5. Next, in order to control your air conditioner using the Maevi app, you need to sync Maevi AC Controller with your air conditioner unit. There are two options available.

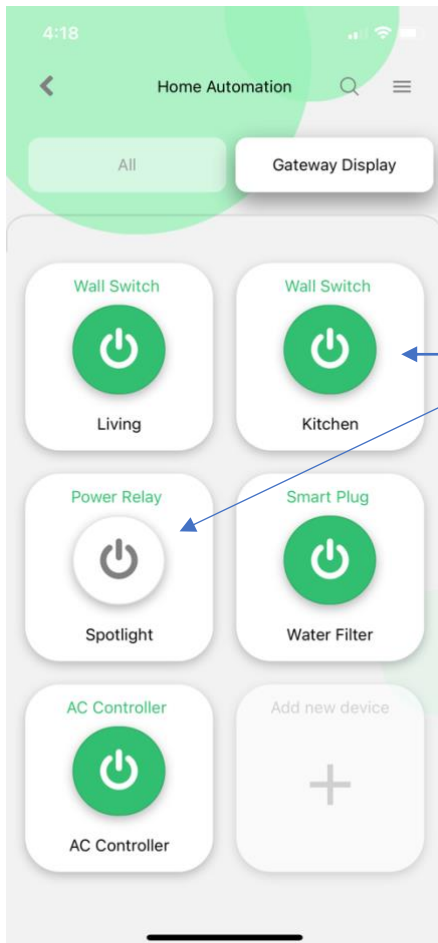

Home Automation Page

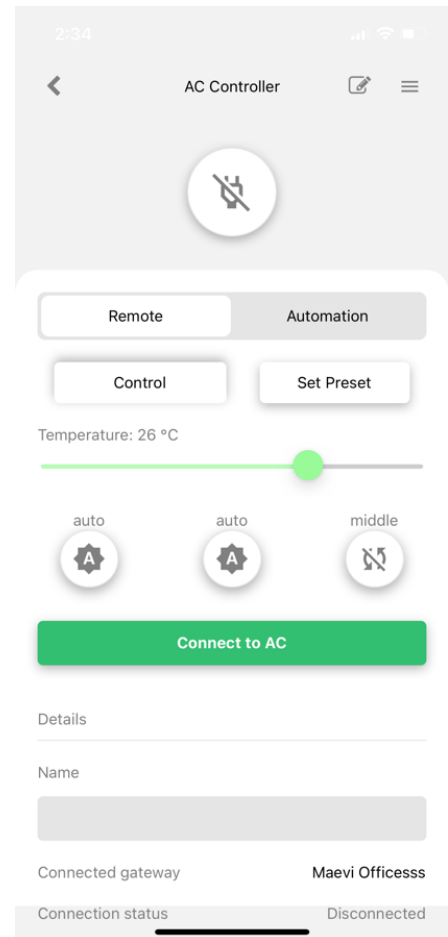

AC Controller Info Page

Option 1: Remote control

1. Turn OFF your air conditioner (AC) using existing remote controller.
2. In Maevi app, open AC Controller page, select 'Connect to AC'.

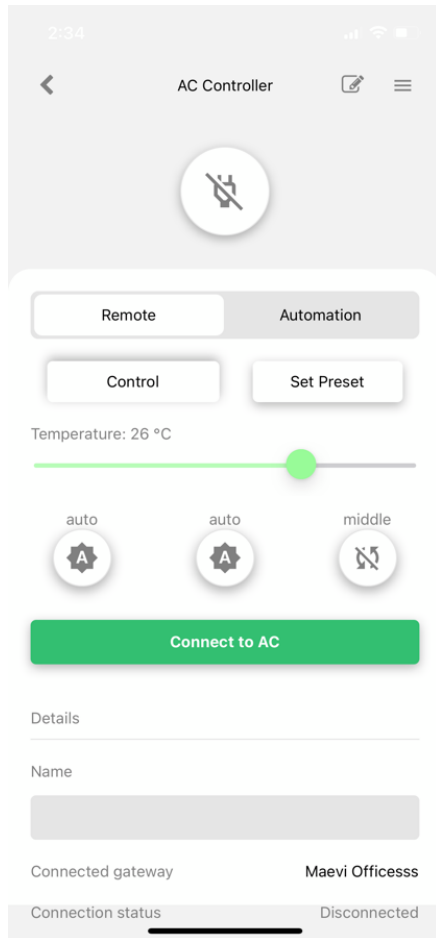

3. Search and Select your AC brand, then select START PAIRING.
Observe your AC while the Maevi AC Controller try to sync with your AC.

Note: You will notice a 120 seconds timer being counted on the LED display of the Split AC Controller. It is now trying to synchronize with the AC unit.

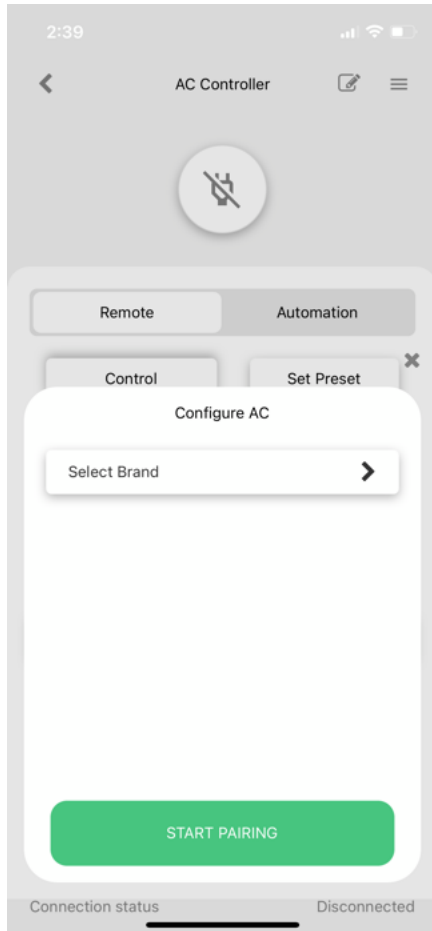

The Maevi AC Controller will successfully connect with your AC when the AC is turn ON automatically. You will hear a ‘beep’ sound from the AC unit, immediately press the ‘Stop’ button.

4. Run some test on the functions below to verify the connection between your AC and Maevi AC Controller.
 - Set Temperature
 - Mode
 - Fan Speed
 - Fan Direction
5. Maevi AC Controller is successfully sync with your AC when your AC making a ‘beep’ sound every time you click the functions on Maevi app.

6. If one of the functions does not trigger anything, you can simply change the channel by select either 'Previous' or 'Next' button continuously until you hear another 'beep' sound from your AC.
7. Repeat step 5 to verify all the functions again.
8. Once every functions verified, select 'CONFIRM'.

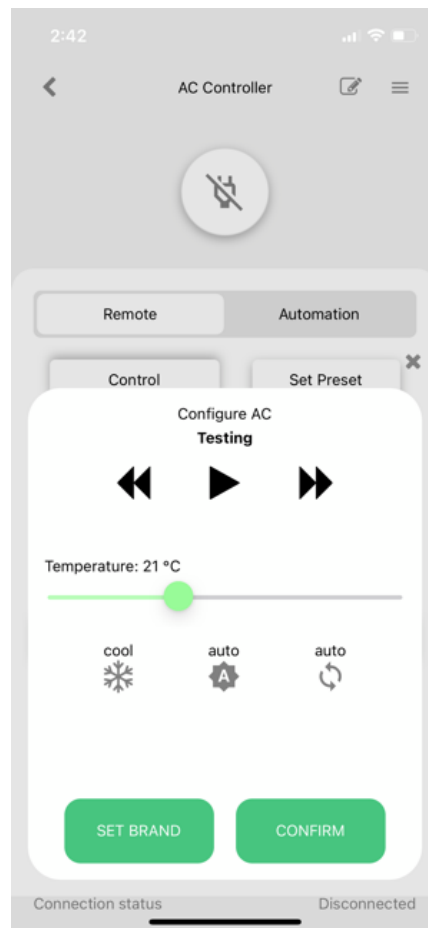
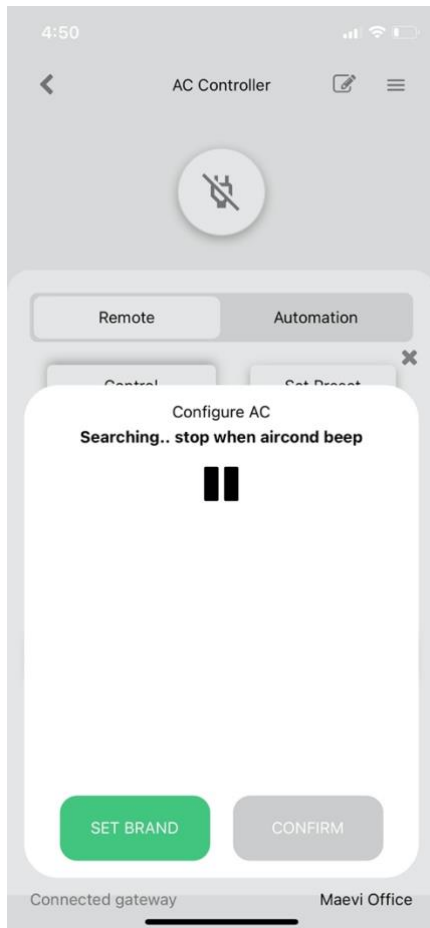

Option 2: Study Mode Control

Use this option if your specific brand or model of AC is not listed in Option 1.

1. Turn OFF your air conditioner (AC) using existing AC remote controller.
2. In Maevi app, open AC Controller page, select 'Set Preset'.

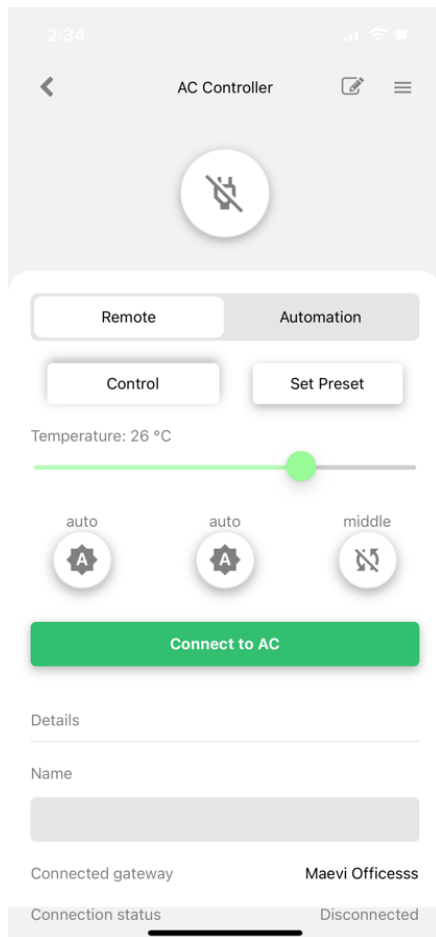

3. Select 'Set new AC preset', then select Button 1, click Confirm.
The AC Controller is ready to be learn. Use the original AC remote controller to copy the desire button.
Note: On Maevi AC Controller's LED display will shows L1 (Refer to Button 1 is ready to learn the command)
4. Point your existing AC remote controller directly to the Maevi AC Controller's LED display.
5. Press and hold the desired button on your existing AC remote controller (Example: ON/OFF button) until Maevi AC Controller's LED display change from L1 to L5.
Note: L5 indicate Learning Successful).
6. Repeat Step 3 to 5 on the next button. You can program up to three commands using this option. (Different functions)

7. If Maevi AC Controller's LED display change from **L1** to **LF**, it means that the learning mode is failed. Repeat Step 3 to 5 again.

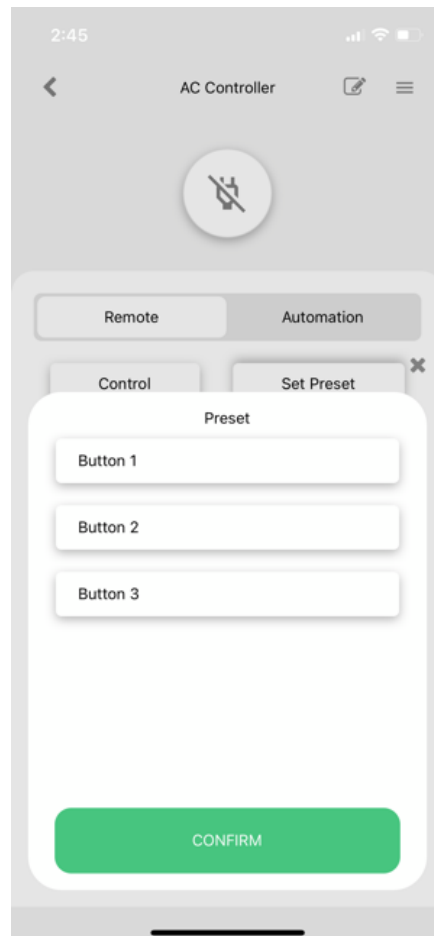
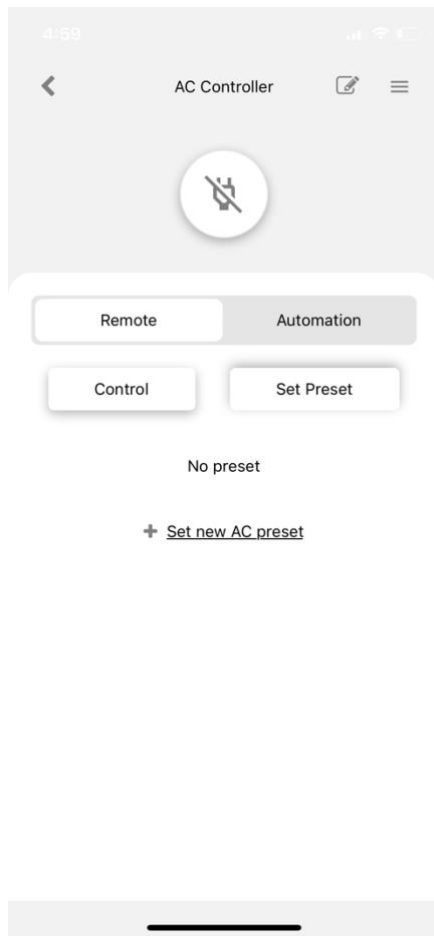

Features

Remote Tab – AC Controller Functions / Remove Device / Rename Device / Device Info

The image displays two screenshots of the maevi mobile application interface, illustrating various features for managing an AC controller.

Left Screenshot (AC Controller Functions):

- Edit Button:** A pencil icon in the top right corner of the AC Controller screen.
- AC Controller Functions:** A bracket groups the following elements:
 - Temperature slider (set to 25 °C)
 - Control buttons: 'off', 'auto' (with gear icon), and 'auto' (with refresh icon)
 - 'Connect to AC' button
- Details Section:** Includes a 'Name' input field and 'Connected gateway' / 'Gateway Display' labels.

Right Screenshot (Device Status/Info):

- To Remove Device:** A red trash can icon in the top right corner.
- To Rename Device:** A callout box pointing to the 'Name' input field.
- Device Status/Info:** A bracket groups the following details:
 - Connection status: **Connected**
 - Device info: Device ID : 91DC90FEFF6E6000:1, Gateway MAC : 00606E0000000000
- To Save Changes:** A callout box pointing to the green 'SAVE' button at the bottom.

Automation Tab - Create Schedule to turn On/Off Air Conditioner

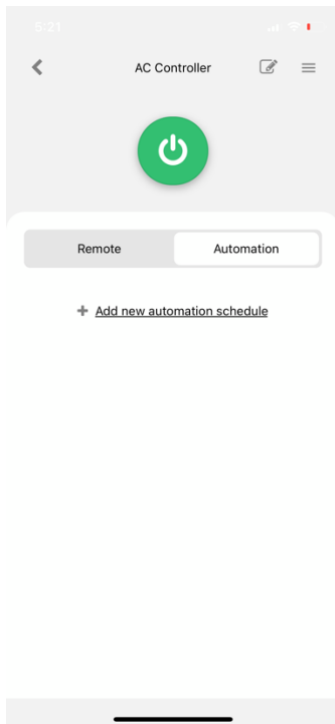

Select **Automation** tab,
tap
+ Add new automation schedule

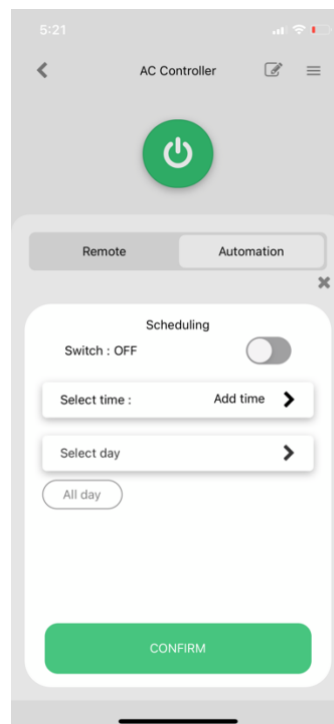

Select status : **ON/OFF**

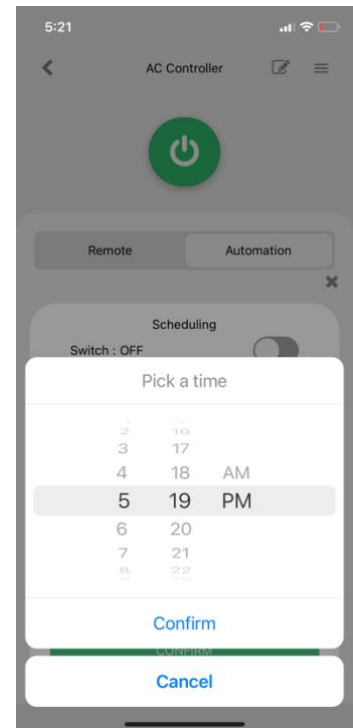

Select **Time**,
tap **Confirm**

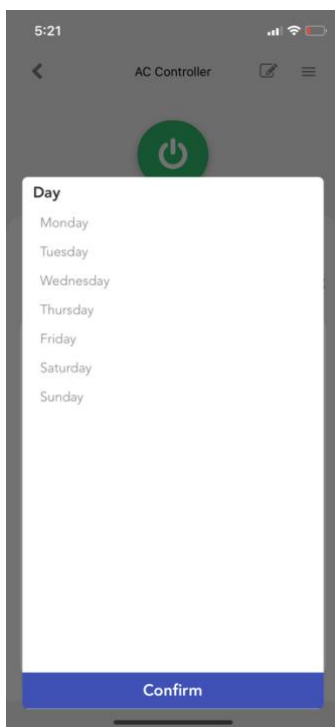

Select **Day**,
tap **Confirm**

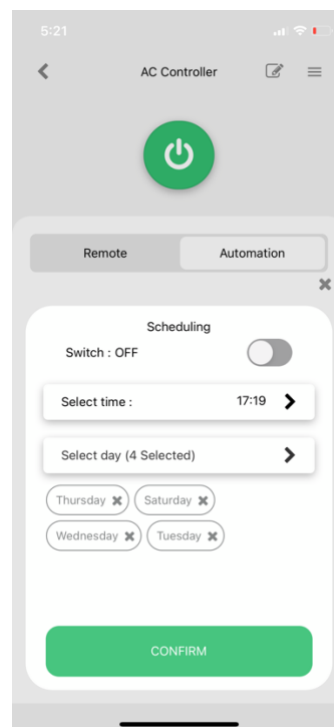

View details,
tap **Confirm**

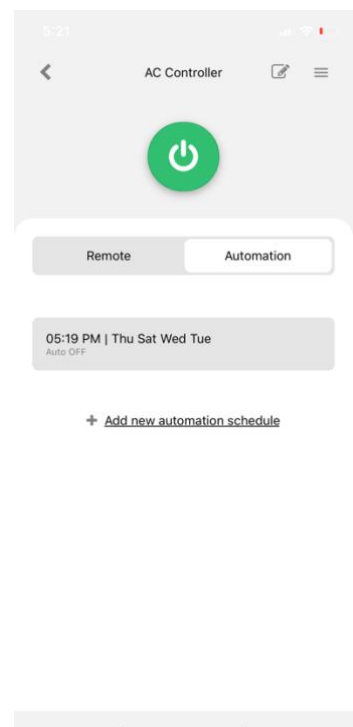

Successful create
schedule

Reset Maevi AC Controller

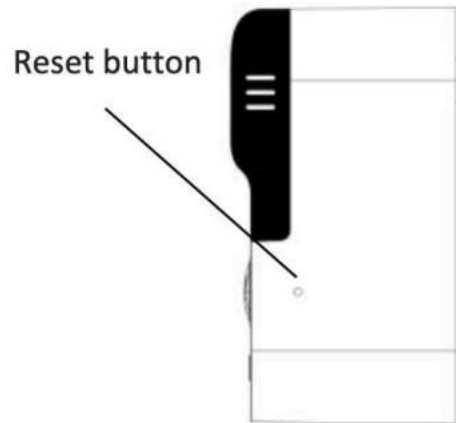

Step:

- 1) Press and hold the reset button until Maevi AC Controller's LED display shows RST and the LED indicator change from orange to red light.
- 2) The device will automatically reset to default factory setting.